

OCEAN CITY'S "IMPERIAL" REELS NOS. 915, 920 AND 921
(Model A)

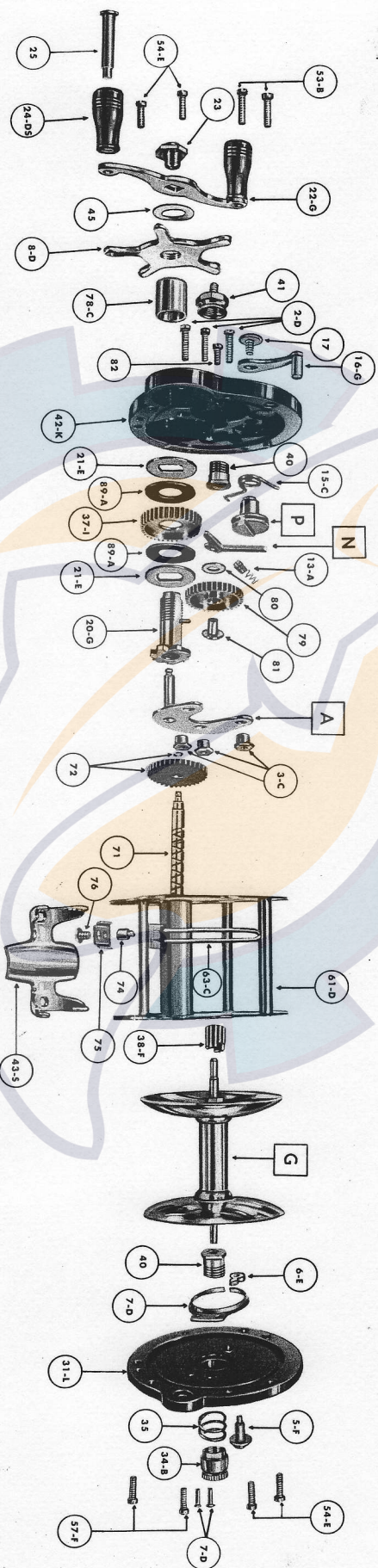

HOW TO ORDER PARTS FOR YOUR REEL—Locate the part desired in the illustration above and note part number. When ordering, state quantity, part name and model letter which you will find on underside of reel stand. Enclose money order, stamps or check. Our minimum charge for one order is \$.25; please add \$.15 on each order for return postage and insurance.

PART No.	PART NAME	PRICE	PART No.	PART NAME	PRICE	PART No.	PART NAME	PRICE	PART No.	PART NAME	PRICE
A 1-1	Bridge (for No. 915 only)	.30	8-D	Drag Star	.32	23	Handle Screw	.26	41	Right Side Adjusting Cap	.12
1-1	Bridge (for No. 920 and 921 only)	.30	14-F	Eccentric (for No. 915 only)	.50	79	Intermediate Gear	.20	44-2E	Spool (for No. 915 and 920)	1.00
2-D	Bridge Screw	.02	14-E	Eccentric (for No. 920 and 921)	.50	80	Intermediate Gear Washer	.01	44-2E	Spool (for No. 921)	1.60
3-C	Bridge Screw Nut	.04	15-C	Eccentric Spring	.12	81	Intermediate Gear Stud	.04	43-S	Stand	.60
5-F	Click Button	.12	16-G	Free Spool Lever	.24	82	Intermediate Gear Stud Screw	.02	53-B	Screw, Right Side Plate	.02
6-E	Click Pawl	.08	17	Free Spool Level Screw	.05	31-1	Left Side Plate (includes parts Nos. 5-F, 6-E, and 7-D)	.50	57-F	Screw, Left Side Stand	.02
7-D	Click Spring and Rivets	.14	61-D	Frame Only (Does not include Part Nos. 71 and 63-C)	1.50	34-B	Left Side Oil Cap	.12	71	Worm	.40
12-6	Drag Dog (for No. 915 only)	.06	20-G	Gear Sleeve and Lock Pin	.60	35	Left Side Oil Cap Spring	.04	72	Worm Gear and Lock Ring	.24
12-F	Drag Dog (for No. 920 and 921 only)	.06	78-C	Gear Sleeve Bushing	.08	40	Left and Right Side Bearing	.20	74	Worm Pawl	.10
13-A	Drag Dog Spring and Plug	.04	22-G	Handle Complete with Knobs	.80	37-1	Main Gear	.45	75	Worm Pawl Cover	.02
89-A	Drag Laminated Washer	.02	24-D	Handle Knob	.14	38-F	Pinion Gear	.30	76	Worm Pawl Cover Screw	.02
21-E	Drag Lock Washer	.05	25	Handle Knob Rivet	.06	42-K	Right Side Plate	.50	63-C	Line Guide	.36
45	Drag Star Top Washer	.04									